

REM Opal Vanity with Upper Storage 05619 (E3-2021)



REM (UK) Limited, Glenfield Mill, Glenfield Road, Nelson, Lancashire BB9 8AW T: +44 (0)1282 619 977 F: +44 (0)1282 619 617 E: sales@rem.co.uk W: www.rem.co.uk

Product Codes:

- 05619 - Opal Vanity with Upper Storage

Standard Equipment:

- Stainless steel worktop and basin with a single hot and cold water chrome tap to centre
- Height positional interior cupboard shelf
- Side storage with glass divider panels
- Mirrored centre section

Optional Equipment:

- N/A

Main Construction:

- MDF, with brushed nickel steel plated handles
- Chrome steel feet
- Stainless Steel Worktop, mirror back

Finish:

- Available in any standard high pressure laminate from the REM range
- Interior of central cupboard always finished in white

Features:

- Choice of REM colours for main body
- Stainless Steel Top and basin
- Single Level Mixer Tap

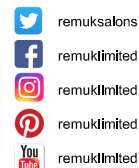

Laminate Finish Options:

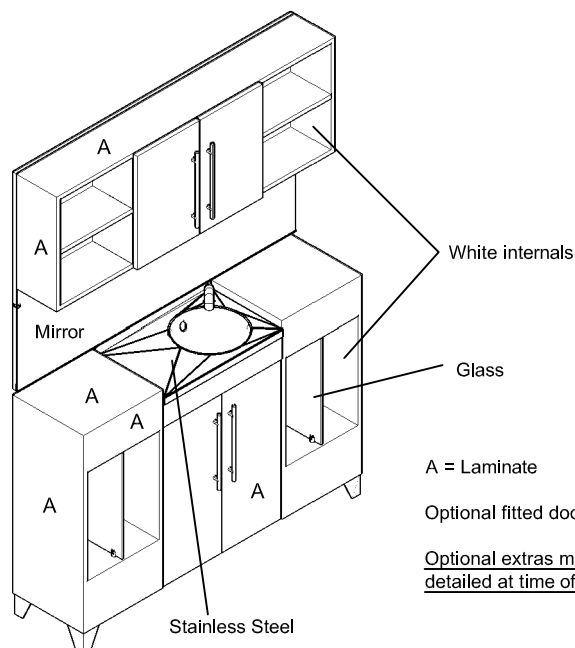
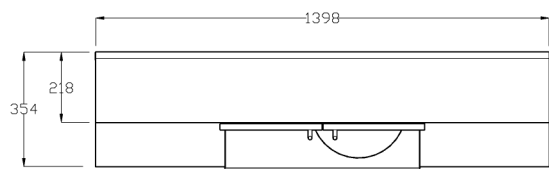
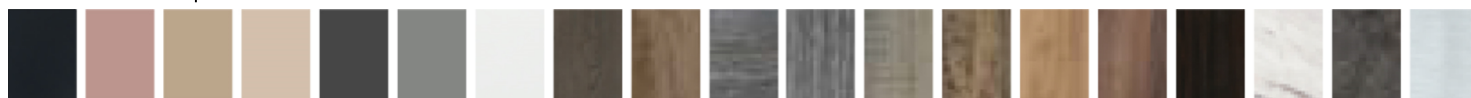

Optional extras must be clearly detailed at time of order.

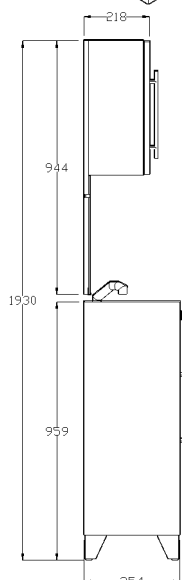
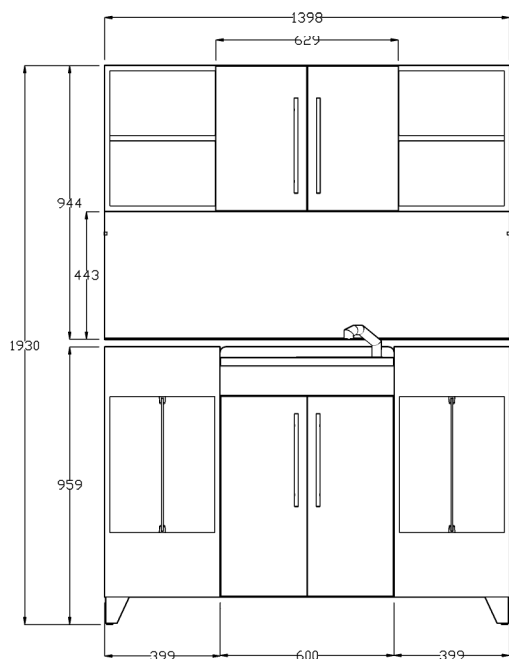

SEALING REM UNITS:

1. MAKE SURE UNIT IS FIXED, LEVEL AND CLEAN.
2. APPLY ADEQUATE AMOUNT OF SILICONE SEAL TO TOP OF CARCASE.
3. FIX TOP OR SINK TO UNIT.
4. APPLY ADEQUATE AMOUNT OF SILICONE SEAL TO ALL AREAS WHERE WATER CAN INGRESS ON WORK SURFACE.
5. APPLY ADEQUATE AMOUNT OF SILICONE SEAL TO BASE AREA OF CARCASE WHERE WATER CAN INGRESS AT BASE OF UNITS.

ALL OUR UNITS SHOULD BE FITTED BY A PROFESSIONAL PERSON