

**Product Codes:**

- 01711 - Mia Pedi Stool

**Standard Equipment:**

- N/A

**Optional Equipment:**

- N/A

**Main Construction:**

- Interior plywood construction with foam toppers.
- Any REM fabric

**Finish:**

- Any fabric from the REM range. All REM fabrics are fire retardant to Crib 5.

**Features:**

- Low seat for use with pedispa
- Upper upholstered buttoning

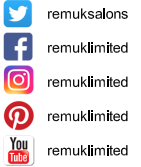

**Fabric Finish Options:**

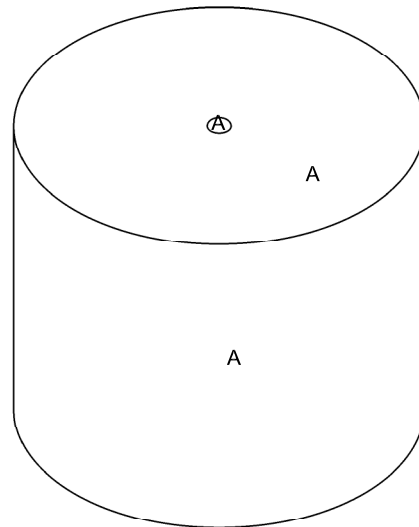
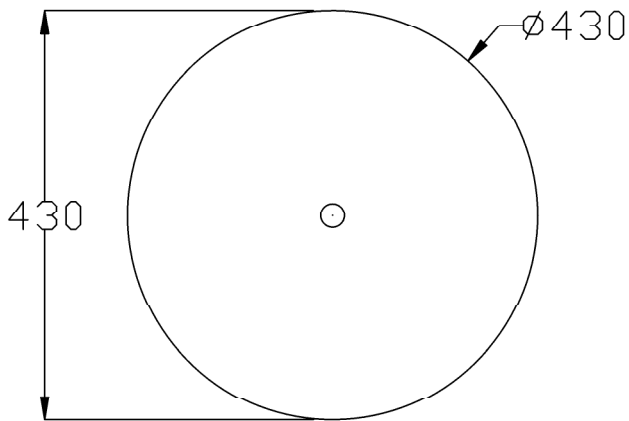

A = Fabric

Unit Options:  
03955 Embroidery

Optional extras must be clearly detailed at time of order.

